



96 Tantawangalo Mtn Rd, CANDELO

HIGH ON THE HILL

Located high on the hill overlooking the vibrant village of Candelo, this home is spectacular.

The home is designed in two distinct sections - the original farm house with kitchen, 3 bedrooms, formal dining room, office and bathroom. The second part of the home is a large extension; connected to the original home at the entrance foyer; and boasting a large living room, 3 bedrooms downstairs, a downstairs bathroom and a parents retreat upstairs including bathroom and large dressing room/office.

All the living areas benefit from facing north and boast spectacular rural views over Candelo, through the valley to the mountain ranges in the distance. The long verandah and deck across the northern side of the house link the two sections of the home and are ideal for entertaining or quiet reflection over a cup of coffee. This home has the rare advantage for a property of this size to be connected to the town water supply.

The old dairy is perfect for storage and a large shed and solid yards complete this pretty hobby farm.

Located on just under 6 acres of titled land plus just over an acre of "paper roads" this is a great size for a few horses or stock.

Call Rod on 0410529517 to arrange an inspection today.

The particulars contained herein are supplied for information only and shall not be taken as a representation in any respect on the part of the vendor or its agent. Interested parties should contact the nominated person or office for full and current details.

TYPE: Sold

INTERNET ID: 9984859

SALE DETAILS

\$625,000

CONTACT DETAILS

Elders Real Estate Bega
Shop 3/248 Carp Street
Bega, NSW
02 6492 1799

Rod McDonald
0410 529 517

Other features: Built-In Wardrobes,Fireplace(s),Garden,Polished Timber Floor,Formal Lounge,Separate Dining

- Bedrooms: 7
- Bathrooms: 3
- Double garage
- Air Conditioning











Lower Level

Upper Level

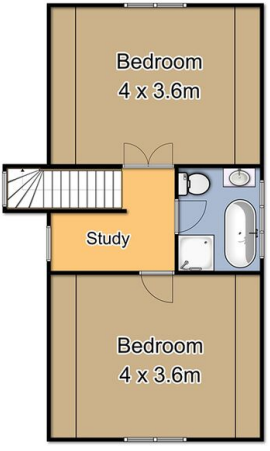

'Hillcrest' Tantawangalo Mountain Road Candelo



Plan is not to scale.
Measurements are approximate
and should be used as a guide only.