

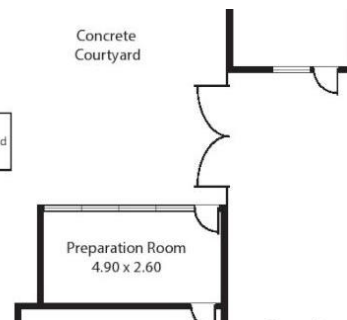

Shop/Prep:	61.94 sqm ( 666.7 sq ft)
Alfresco:	49.00 sqm ( 527.4 sq ft)
Bakehouse:	56.95 sqm ( 613.0 sq ft)
Total:	167.89 sqm ( 1807.1 sq ft)

This Drawing is for illustration purposes only. All measurements are approximate and details intended to be relied upon should be independently verified.

Concrete Courtyard



## 21 Seventh Street, MURRAY BRIDGE

Freehold Commercial Opportunity in the Heart of Murray Bridge

Prominent CBD location

Ideal for cafe or offices

Total Building 167.8 sqm, Rear storage, including toilet 56sqm, covered outdoor area 49sqm

Formerly family Bakery business

Bakery plant and equipment not included

Rare opportunity in this sought after high profile location.

Blank canvas to let your imagination run wild!

\* Some Photos for illustration Purposes

- Land Area 235 square metres
- Commercial Type: Retail
- Building Area: 169 square metres
- Zoning: RTCE/11

**TYPE:** For Sale

**INTERNET ID:** 11109089

**SALE DETAILS**

**\$270,000 + GST**

**CONTACT DETAILS**

**Murray Bridge**

201 Adelaide Road  
MURRAY BRIDGE, SA

08 8531 9200

RLA: 62833

**Gavin Clarke**

0417 859 733

