



140 Mine Flat Road, STRATHALBYN

"Groombridge" Moments from town on 40 majestic acres.

16.25 hectares, 40.15 acres

So close but just far enough away & offering so much more than a country lifestyle.

A place to call home on 16.25ha (40acs) with 1 freehold title of attractive grazing country.

If space & privacy are paramount with room for the family & the four legged friends, we have it covered in spades.

The homestead & improvements are located on the flat with healthy rising acreage for livestock with big, big views of the surrounding district - a perfect combination.

Majestic gums & historic stone fencing act as a tribute to our pioneering & hardworking past & rekindle an earlier era.

The brick veneer 1985 Fairmont built home has all that you would expect of comfortable digs with 3 bedrooms, spacious family & living areas with air conditioning & wood heater. Don't worry, you will never ever run out of firewood!

Plenty of shedding & outbuildings will provide a haven for the handyman or collector to lose a few hours.

TYPE: For Sale

INTERNET ID: 10360870

SALE DETAILS

\$635,000-\$649,000

CONTACT DETAILS

Elders Victor Harbor
11-13 Victoria Street
VICTOR HARBOR, SA
08 8555 9000
RLA: 62833

**Paul Clifford Elders Hills
and Fleurieu**
0427 796 144

Water to the property is supplied via the fully equipped bore (stock & domestic supply) & approx. 50,000 gallons of rain water storage.

The property is fenced to 10 paddocks with easy access to the equipped shearing shed & holding yard if sheep are your thing.

Located on a quiet country lane that sees minimal traffic but is only a stones throw from the main Strath-Wistow Road.

An easy commute to Adelaide when required & just minutes back into town for supplies, services & schooling.

"Come home to a simpler life!"

C.T.- 5933/547.

Allotment 40 / DP 65828.

Hundred of Strathalbyn.

Council Area- Alexandrina.

Zoning- Primary Production.

Land Area- 16.25ha (40acs).

Year Built- 1985.

Paul Clifford 0427 796 144 Elders Hills & Fleurieu.

- Land Area 16.25 hectares
- Bedrooms: 3
- Bathrooms: 1

HOMESTEAD

Bedrooms	3
Bathrooms	1







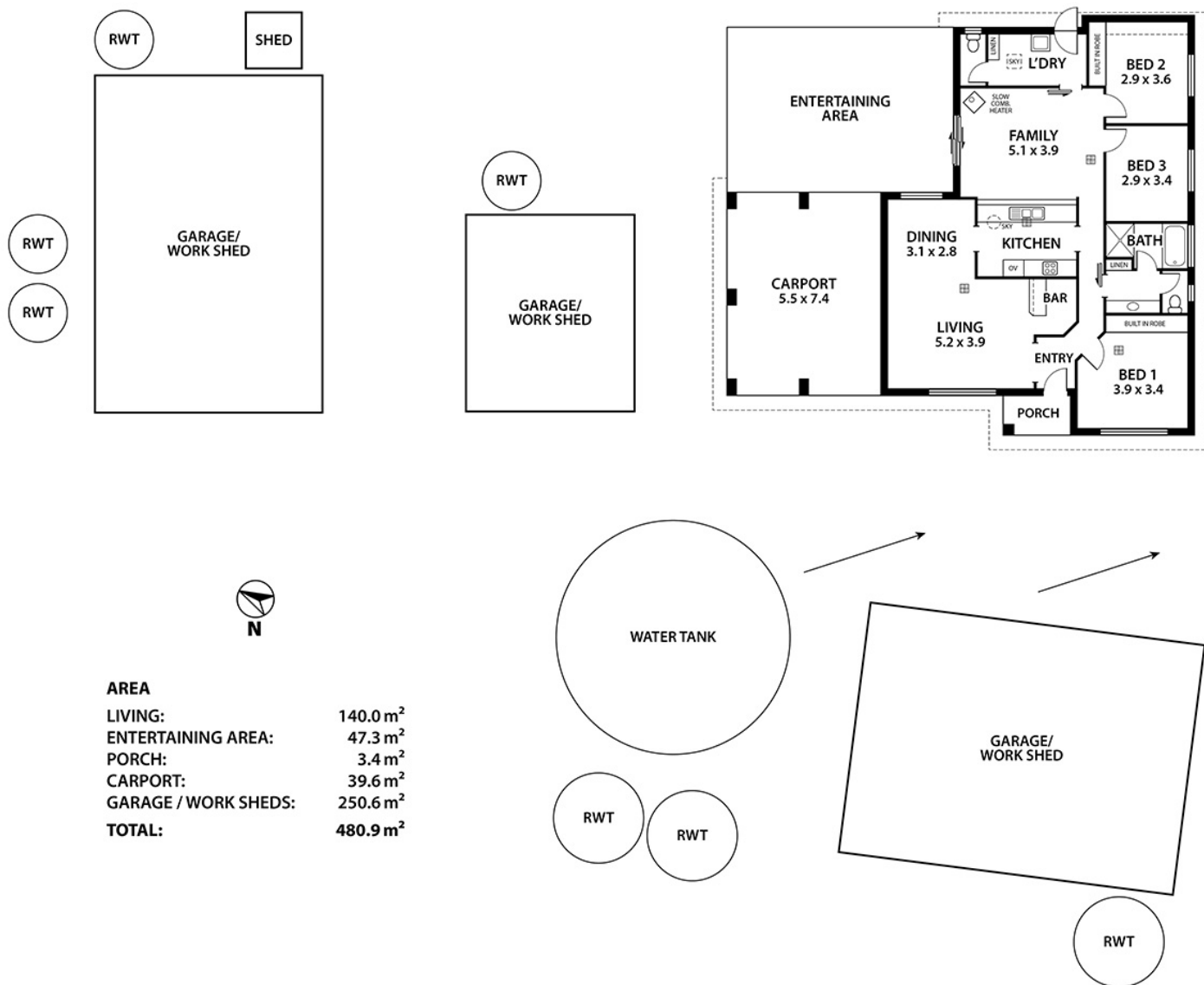

This floorplan is for illustration purposes only and all measurements are approximate. Any information that is intended to be relied upon should be independently verified. Neither the agent or the illustrators take any responsibility for any omission, wrongful inclusion or typographical error which may occur in this drawing as it is intended as an artist's impression only. While every endeavor has been made to verify the correct details in this floor plan, neither the agent, vendor, nor illustrators accept any responsibility for any error or omission.